

**GERKO**

PAINT RELATED PRODUCTS



# MOBILE VACUUM CLEANER WITH AUTO FILTER CLEANING M-CLASS 40L VC1000 - MANUAL



[WWW.GERKOPRODUCTS.COM](http://WWW.GERKOPRODUCTS.COM)



Read the instruction manual carefully before operation!

Machine preparation, operation and maintenance of general safety instructions are stated in the manual. When use must comply with the instructions. If not caused accidents, manufacturers will be not responsible for it.

### **SAFETY USE CONSIDERATIONS**

1. Don't use in flammable liquid, gas, or with explosion-proof requirements region, protect from fire
2. Turn off the switch and take off plug before clean or repair to avoid the risk from fire
3. Hose and the body may cause electrostatic, pay attention to this
4. Don't trample, pulling folding hose, when hose is damaged, do not continue use, don't use heavy or sharp blade pressure hose
5. Don't let the power cord clamp in the crack of the door or use cord pulling the vacuum cleaner, protect the cord
6. Protect own safety when use, keep the body away from the vacuum cleaner suction or activity parts
7. Avoid put the whole machine in the water, don't touch the plug with wet hands or a wet towel, to prevent electric shock
8. Voltage must be consistent with the power supply voltage, don't use beyond the voltage range
9. Before water absorption, please remove the dust bags, filters, use the sponge filter
10. Keep clean when the tank have a lot of dust

### **WARNING**

1. Don't let the glass, tack, iron and other sharp debris remaining in the hose, body, otherwise it will damage the hose, filter bag, etc
2. Don't inhale hot, fire and caustic, flammable and explosive objects, avoid the risk from fire or electric shocking
3. Inhalation of hair, paper, cement, lime, putty powder, sticky objects will easily block the vacuum, caused fire, not recommend suction these object
4. Don't use long time when the air inlet is blocking, otherwise will damage the vacuum
5. Stop use when abnormal sound, checking and clean
6. Please don't let children use a vacuum cleaner accessories as a toy, in order to prevent the accident
7. When the electricity is big, use separated patch board, prevent from fire
8. Pull off the plug when not use, in working status, do not leave.
9. Don't keep the vacuum or cord near the hot sources, protect from fire
10. Don't use damaged cord and plug, if broken, must be repaired by professionals

**WARNING**



1. This machine is for indoor use only
2. This machine shall be stored indoors only
3. Clean the water level limiting device regularly and examine it for signs of damage

The M-CLASS has been third party tested and certified to M Class standards.



Delay type fuse, stable current 2A



Delay type fuse, stable current 2A

**IMPORTANT SAFETY INSTRUCTIONS**

1. The appliances are dry and wet suction for commercial use and only indoor use.
2. If the supply cord is damaged, it must be replaced by a special cord or assembly available from the manufacturer or its service agent.
3. This appliance is not intended for use by persons(including children)with reduced physical, sensory or mental capabilities or lack of experience and knowledge, unless they have been given supervision or instruction concerning use of the appliance by a person responsible for their safety.Children
4. Should be supervised to ensure that they do not play with the appliance.
5. Children should be supervised to ensure that they do not play with the appliance.
6. Cleaning and user maintenance shall not be made by children without supervision

**TECHNICAL DATA**

THE VIBRATION VALUE OF HANDLE IS BELOW 2.5M/S2			
Rated voltage	220-240V	Vacuum(KPa)	19
Rated frequency	50/60Hz	Max.flow rate(m <sup>3</sup> /h)	1.8
Rated power	1600W	Sound pressure level	82dB
Dust classes	Class M	N.W. Weigh	16.3kg

**MAIN COMPONENTS**

NO	NAME	NO	NAME	NO	NAME
1	Floor brush for option	8	Switch	15	Cable
2	Telescope tube for option	9	Protection switch	16	Side latch
3	Hook for option	10	Hose connector	17	Big wheel
4	Pneumatic outlet For option	11	Remote control For option	18	Wheel Cover plate
5	Electrical outlet	12	Hose	19	Dust tank
6	Gear knob	13	Pushing rod	20	Suction
7	Speed control knob	14	Hose holder	21	Universal wheel

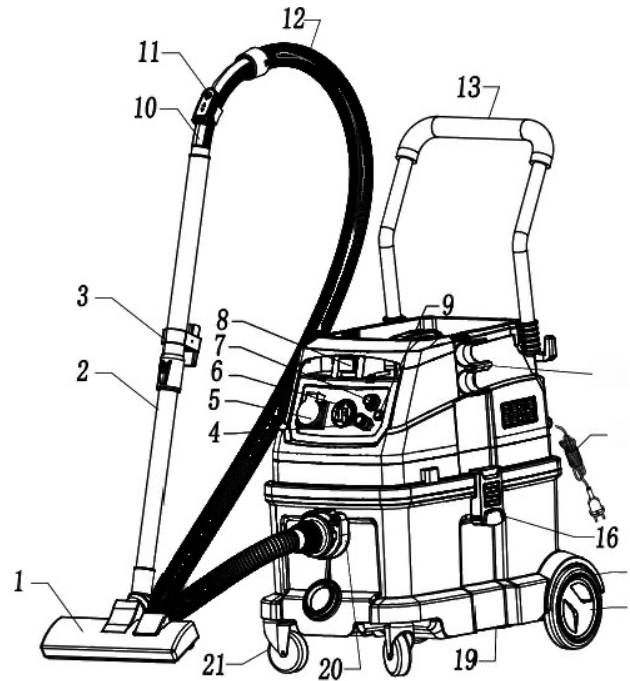

**PACKING LIST**

NAME	QUANTITY	NAME	QUANTITY
Vacuum cleaner	1	Manuals	1
Hose	2	Small wheel	2
Hose adaptor	2	Big wheel assembly	1
Non-woven bag	1	Screw	4
Round brush	1	Small nozzle	1



**OPERATION METHOD**

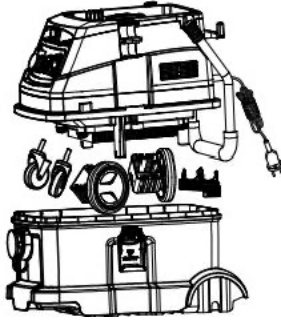

1. Release the lock catch to open the up housing, take out wheels and accessories

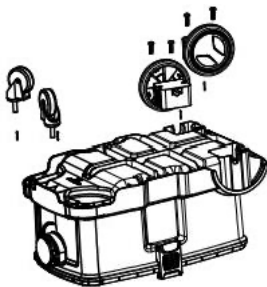

2a. Install the large wheel assembly into a plastic bucket and secure it with two screws

2b. Insert the universal wheel into the plastic bucket

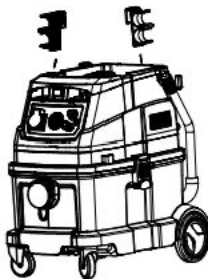

3. Install the hose holder on the machine, taking care to insert the bottom into the slot on the body of the machine

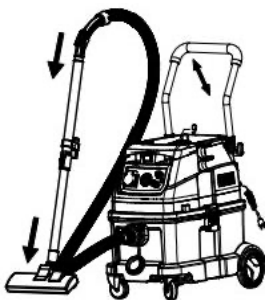

4. Insert the hose connector into the suction port of the machine, rotate it in place clockwise, insert the elbow into the metal pipe, and insert the other end of the metal pipe into the floor brush

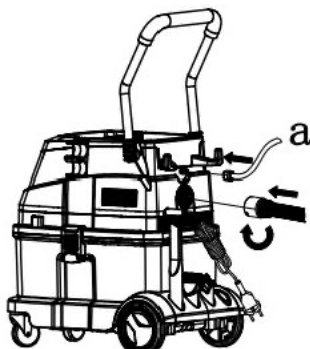

5a. Step 1, connect to the air compressor Step 2, insert the tool connector into "4" Step 3: Rotate the switch knob counterclockwise, synchronous working with air tool function

5b. Insert hose, blow function

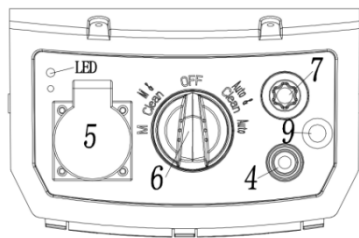

6. Functions of each component:  
 "4" Connect the pneumatic tool connector  
 "5" Connect the electric tool connector  
 "6" Switch  
 "7" Increase power clockwise  
 "8" When the whole machine current greater than 15A, automatic shut down, press the reset button, you can restart.

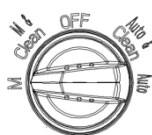

Works in sync with pneumatic or electric tools



Works in sync with pneumatic or electric tools and Hepa can cleaned automatically



Turn it off



Only the vacuum cleaner function and the Hepa can cleaned automatically



Only the vacuum cleaner function

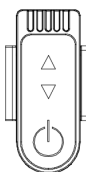

When the vacuum cleaner is working,the remote control can be used to control the starting and stopping of the motor and the speed regulating function

Notice:during the Hepa be cleaned automatically,the automatic dust shaking function will be started every 20s,and you will hear the sound.This is the normal working state,so you don't need to worry.

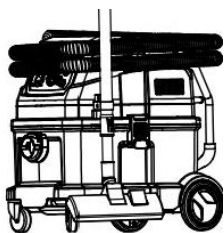

7. When the machine is not in use, you can store the components as shown

**TO REPLACE DUST BARREL**

IF the dust barrel is full, please empty it as soon as possible

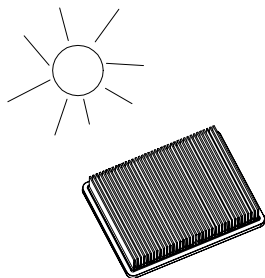
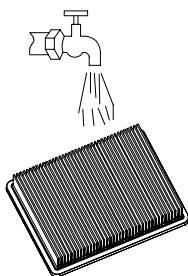
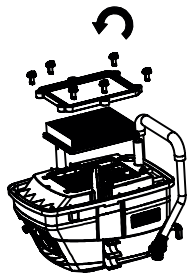
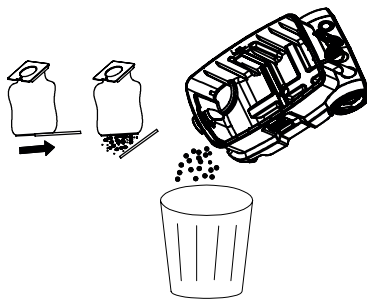
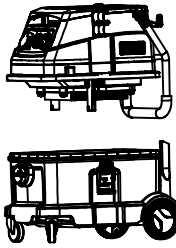

8. Release the buckle and remove the up housing assembly

9. Clean up the garbage

- a. The dust bag is taken out and thrown into the garbage can (If equipped with paper bags)
- b. Put the garbage in the garbage can

10. Turn anticlockwise as shown in the figure to release 6 locking hooks and take out the Hepa filter

Notice: when loading the Hepa filter, turn the lock hook in the opposite direction

11. Wash the Hepa filter under tap water instead of brush.

12. The Hepa filter can be dried in the sun or naturally.

### MAINTENANCE

- Automatic cleaning
- Powerful and compact
- Wet & Dry
- Multiple air filter system guarantees a hygienic cleaning
- Electrical outlet for the electric tools
- Special parking position for easy use and space saving
- Rotary wheels facilitate moving and running
- Divers accessories
- User-friendly design

### MAINTENANCE

- In order to lengthen the life time, single using time is better not more than 20 minutes
- In order to lengthen the life time, clean the body, filter and dust bag after use.
- Twine the power cord well, put accessories in slot
- Clean the dirty water after using to prevent the rusting or corrosion of barrel.
- Clean the surface of vacuum cleaner with dry cloth to prevent water into vacuum cleaner caused short circuit even vacuum cleaner burning

### COMMON FAULT GUIDES

FAULT	POSSIBLE REASON	HANDLING METHOD
<b>Motor failure</b>	<ol style="list-style-type: none"> <li>1. Check power plug if it is wired up properly?</li> <li>2. Check power socket if it is electricity?</li> <li>3. Check the switch if it is turned on</li> </ol>	<ol style="list-style-type: none"> <li>1. Plug into the socket again</li> <li>2. Make sure the power socket is electricity</li> <li>3. Turn on the switch</li> </ol>
<b>Suction abate</b>	<ol style="list-style-type: none"> <li>1. Check brush, hose and telescopic tube if they are blocked?</li> <li>2. Check dust bag if it is with full dust?</li> <li>3. Check the filter if it is blocked</li> </ol>	<ol style="list-style-type: none"> <li>1. Clean the blockages</li> <li>2. Clean the dust bag</li> <li>3. Clean the filter</li> </ol>
<b>Hot air outlet</b>	<ol style="list-style-type: none"> <li>1. Check the suction if it is normal</li> <li>2. Check the using time if it is more than 20 minutes</li> </ol>	<ol style="list-style-type: none"> <li>1. The hot air from vacuum cleaner is caused by motor heat conducting. It's common, pls continue to use.</li> <li>2. turn off to rest 20 minute before use again.</li> </ol>